



Product Information

The Sleeve Anchor is an all steel, thin walled, through fixing for general purpose applications Suitable for fixing into Concrete, Solid Brick, Dense Blockwork Some Natural Stone
Finish available :-
Zinc Plated and Yellow Passivated min 5µm
Stainless Steel Grade A4 - 316

Features

1. All Steel anchor
2. Through fixing
3. Optimum collapse feature to ensure maximum clamping force
4. Stainless Steel Sleeve available

Part Number		Thread Diam	Drill Hole Diam	Anchor Length	Maximum Fixture Thickness	Embedment Depth	Minimum Hole Depth	Fixture Clearance Hole	Min Structure Thickness	Tightening Torque
Hex Nut BZP	Hex Nut SS	mm	mm	mm	mm	mm	mm	mm	mm	Nm
	SLSS06060	4.5	6	60	25	30	35	7	50	10
SLN08040	SLSS08040	6	8	40	8	30	35	9	60	20
SLN08065	SLSS08065			65	30	35	40			
SLN08085				85	50					
SLN10050	SLSS10050	8	10	50	8	40	45	12	70	40
SLN10075	SLSS10075			75	35					
SLN10100	SLSS10100			100	60					
SLN10125				125	80					
SLN12060	SLSS12060	10	12	60	10	45	50	14	90	65
SLN12075	SLSS12075			75	22	50	60			
SLN12100	SLSS12100			100	45					
SLN12125				125	70					
SLN16065		12	16	65	12	50	60	18	95	90
SLN16110				110	49	55	65			
SLN16150				150	90					
SLN20080		16	20	80	14	60	70	22	100	165
SLN20110				110	47					
SLN20150				150	90					

Installation Instructions

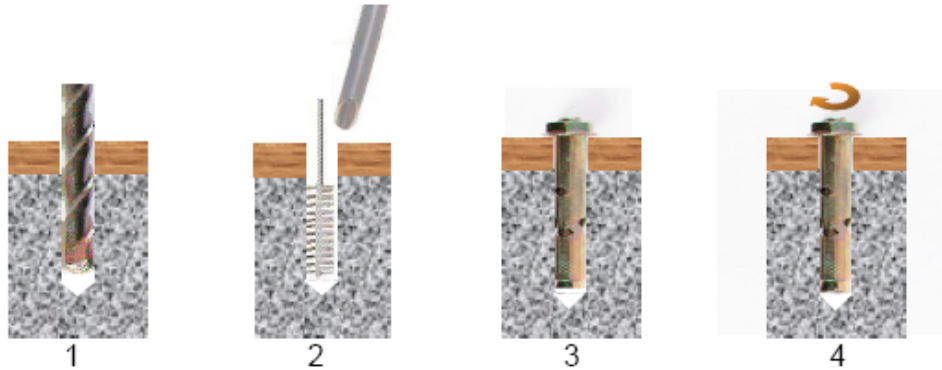

- 1 Position fixture and drill correct diameter hole to minimum recommended depth through fixture
- 2 Clean hole by brushing and blowing to remove drilling debris and dust
- 3 Insert Sleeve Anchor through fixture into drilled hole
- 4 Tighten anchor to recommended Torque.

